

## Z系列带附板输送链 Conveyor chains with attachments (Z series)

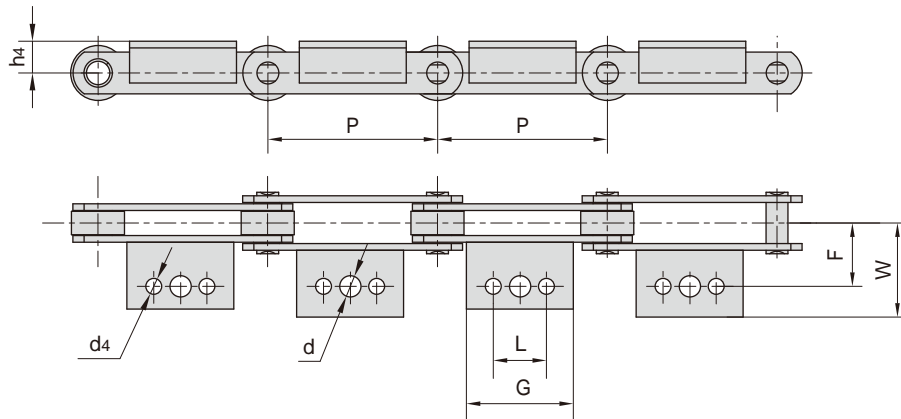

东华链号 Donghua Chain No.	P	L	G	d	d4	F	W	h4
	mm	mm	mm	mm	mm	mm	mm	mm
Z40	50.8	-	45.0	10.7	9.3	38.1	64.5	19.0
	63.5	22.2	43.0				56.0	
	76.2						68.0	
	88.9	31.8	50.0				56.0	
	101.6		64.0				55.0	
	127.0	57.2	84.0				56.0	
Z100	76.2	-	30.0	14.0	10.5	44.5	65.0	32.0
	88.9							
	101.6	31.8	64.0					
	127.0	57.2	84.0					
	152.4		114.5					
	177.8	80.0	110.0					
Z160	101.6	-	35.0	15.5	12.3	54.0	77.0	38.0
	127.0	31.7	56.0					
	152.4	57.2	84.0					
	177.8							
	203.2	100.0	130.0					
	228.6		150.0					
Z300	254.0	135.0	170.0	17.0	14.0	73.0	100.0	51.0
	152.4	38.1	70.0					
	177.8							
	203.2	76.2	100.0					
	254.0	90.0	152.4					
	304.8	190.0	225.0					

表示附板带1个孔  
attachments with 1 hole

表示附板带2个孔  
attachments with 2 holes

表示附板带3个孔  
attachments with 3 holes